

FITTING INSTRUCTIONS

Toyota Landcruiser VDJ79 – T7T699



Max Towing Capacity: 3500Kg	Towbar Weight: Approx. 25Kg
Max Ball Load: 350Kg	Wiring Harness Part #: UNT272



Tools Required:

M10,12,14 Spanners/Socket, Torque Wrench (**Torque M10 to 60Nm, M12 to 100Nm, M14 to 170Nm**)

Kit Contents					
Item No.	Description	Qty	Item No.	Description	Qty
1.	Towbar Centre Section	1x	8.	M10x40x1.25 Bolt	4x
2.	Towbar End Plate Passenger Side	1x	9.	M10 Flat Washer	4x
3.	Towbar End Plate Drivers Side	1x	10.	M10 Shake Proof Washer	4x
4.	M12x45x1.25 Bolt	10x	11.	M14x40x1.5 Bolt	4x
5.	M12 Shake Proof Washer	10x	12.	M14 Shake Proof	4x
6.	M12 Flat Washer	18x	13.	M14 Flat Washer	4x
7.	M12x1.25 Nut	8x	14.	Tapped Plate M12	2x

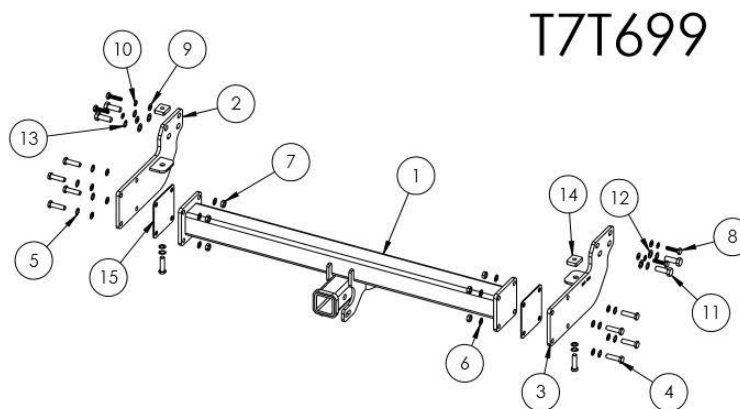

Warning:

- This product is for towing purposes only and must only be loaded as shown in your vehicle Owners Manual.
- This towbar is NOT to be drilled, cut, welded or modified in any way.
- Check behind chassis rail and body panels before drilling to ensure no hazards are present

General:

- Before fitting this towbar read fitting instructions and check installation hardware is correct.
- Check that the towbar is suitable for the vehicle and be wary of any changes to the vehicle design that may conflict with the fitting of this towbar.
- After drilling, blow any filings clear, remove any swarf and treat exposed metal with a rust inhibitor.
- If this vehicle requires a bumper cut out, please check to make sure that you measure twice and check twice before cutting any panels as some bumper profiles can change. If you are not sure, then please ask your towbar supplier

FITTING INSTRUCTIONS

Toyota Landcruiser VDJ79 – T7T699



Step 1 Lower the Exhaust		
Instructions	Tools	Fasteners/Torques
Remove 2 x rear exhaust mount screws to allow for more space to install the towbar.	M10 Spanner	NA

Step 2 Attach Towbar End Plates		
Instructions	Tools	Fasteners/Torques
Loosely secure both towbar end plates to the chassis. <ul style="list-style-type: none">- Using 2x M10 Bolts, Flat and Shake Proof washers in the top 2 holes on outside of each chassis rail- Using 2x M14 Bolts, Flat and Shake Proof Washers in the bottom 2 holes on the outside of each chassis rail- Using 1 x M12 Bolt, Flat and Shake Proof Washer and the Tapped Plate through the mounting point on the bottom of each chassis rail. Tighten the bolts to hold the end plates against the chassis rails. DO NOT tighten to torque spec.	-M10, 12, 14 Spanners and Sockets	NA

Step 3 Determine if Spacers are required		
Instructions	Tools	Fasteners/Torques
Position the Towbar centre section between the two end plates. If there is more than approx. 3mm clearance between the parts of each side, then spacers will be required. If the clearance is less than this, spacers will not be required between the parts	NA	NA

Step 4 Secure Towbar Centre Section and Torque Bolts		
Instructions	Tools	Fasteners/Torques
Using 4x M12 Bolts, Shake Proof Washers and Bolts, 8x M12 Flat Washers, and 1x Spacer (if required) per side. Loosely secure the towbar centre section between the end plates. Ensure centre section is right side up with the hitch receiver bellow the main cross-bar. When all hardware is in place, tighten all bolts (including those into the chassis rails) to the torque specified.	-M10, 12, 14 Spanners and Sockets -Torque Wrench	M10 = 60Nm M12 = 100Nm M14 = 170Nm

FITTING INSTRUCTIONS

Toyota Landcruiser VDJ79 – T7T699



Step 5 Resecure the Exhaust		
Instructions	Tools	Fasteners/Torques
Attach the rear Exhaust mount that was removed in step one. Tighten to torque specified in vehicle owner's manual.	-M10 Spanner, socket -Torque Wrench	See Vehicle Owner's Manual

Step 6 Apply Sticker to Door Jam		
Instructions	Tools	Fasteners/Torques
Apply Towbar info label to the inside of the driver's side door Jam.	NA	NA



WARRANTY STATEMENT

The manufacturer of TAG branded products, warrants your TAG Towbar for its full product life under the following conditions:

- You can show proof of purchase.
- The towbar has been correctly installed by a suitably qualified installer.
- The towbar has not been modified or abused in any way and has only been used for the purpose intended.
- The towbar was not fitted second hand to your vehicle.

The extent of this warranty includes materials and workmanship used in the manufacture of the towbar and is to the equivalent value of current, full replacement cost.

Nothing stated or implied in this warranty limits in any way, the statutory rights that you may have.

To make a claim visit the original installer in the first instance or, if you are unable to or are not satisfied with their help, then contact us direct by phone on 07 3208 3022 or via email qldsales@arandatowbars.com.au