

# FITTING INSTRUCTIONS

Toyota Prado 120/150 (Spare on door) – T7T729



**Max Towing Capacity:** 3000kg

**Towbar Weight:** 20kg

**Max Ball Load:** 300kg

**Wiring Harness Part #:** 120-UNT236 150-UNT282



## Tools Required:

- Spanners, Sockets, Torque Wrench, Drill

Kit Contents					
Item No.	Description	Qty	Item No.	Description	Qty
1.	Towbar Centre Section	1	10.	M12x1.25x45 Bolt	14
2.	End Plate PS	1	11.	M10x1.5x30 Bolt	2
3.	End Plate DS	1	12.	M10 Shake Proof Washer	2
4.	M12x1.25 Nut on Wire	2	13.	M10 Flat Washer	2
5.	Top Plate	2	14.	M10x1.5 Nut Plate on Wire	2
6.	M12x1.25 Nut	8	15.	Hitch Collar Cover	1
7.	M12 Shake Proof Washer	14	16.	Pin & Clip	1
8.	M12 Flat Washer	22	...	D-Shackles	2
9.	Spacer 3mm	2	...	Compliance Sticker	1

T7T729

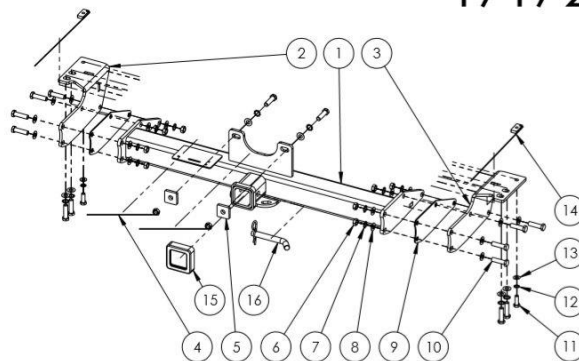

## Warning:

- This product is for towing purposes only and must only be loaded as shown in your vehicle Owners Manual.
- This towbar is NOT to be drilled, cut, welded or modified in any way.
- Check behind chassis rail and body panels before drilling to ensure no hazards are present

## General:

- Before fitting this towbar read fitting instructions and check installation hardware is correct.
- Check that the towbar is suitable for the vehicle and be wary of any changes to the vehicle design that may conflict with the fitting of this towbar.
- After drilling, blow any filings clear, remove any swarf and treat exposed metal with a rust inhibitor.
- If this vehicle requires a bumper cut out, please check to make sure that you measure twice and check twice before cutting any panels as some bumper profiles can change. If you are not sure, then please ask your towbar supplier

# FITTING INSTRUCTIONS

Toyota Prado 120/150 (Spare on door) – T7T729



## Step 1 Fit Towbar End Plate



Instructions	Tools	Torque Spec
Loosely secure both towbar end plates to the chassis. - Using 2x M12 Bolt, Flat and Shake Proof Washers into the captive nuts in the bottom of each chassis rail, through the rear most 2 holes in the end plate Tighten the bolts to hold the end plates against the chassis rails. <b>DO NOT tighten to torque spec.</b>	Spanners, Sockets	NA

## Step 2 Determine if Spacers are Required



Instructions	Tools	Torque Spec
Position the Towbar centre section between the two end plates. If there is more than approx. 3mm clearance between the parts on each side, then spacers will be required. If the clearance is less than this, spacers will not be required between the parts.	NA	NA

# FITTING INSTRUCTIONS

Toyota Prado 120/150 (Spare on door) – T7T729



## Step 3 | Secure Towbar Centre Section



Instructions	Tools	Torque Spec
<p>Secure Towbar Centre section to the end plates:</p> <ul style="list-style-type: none"> <li>- Using 4x M12x45 Bolts, Shake Proof Washers, M12 Nuts, 8x M12 Flat Washers, and 1x Spacer (if required) per side. Loosely secure the towbar centre section between the end plates. Ensure centre section is right side up with the chain mount below the hitch receiver</li> </ul> <p>Secure centre section to the chassis:</p> <ul style="list-style-type: none"> <li>- Using 2x M12 Bolts, Flat and Shake Proof Washers, 2x Top Plates (1 on each bolt) between the towbar and chassis and 2x nut on M12 Nut on wire (inside the chassis)</li> </ul> <p>When all hardware is in place, tighten <b>all</b> bolts (including those into the chassis rails) to the torque specified.</p> <p>Finally Drill the 3<sup>rd</sup> hole in the bottom of the chassis rail:</p> <ul style="list-style-type: none"> <li>- Drill through the forward most mounting point in the end plate, drill a pilot hole and then finish with an 11mm drill bit. Fix using 1x M10 Bolt, Flat and Shake Proof Washer on each side, into the Nut Plate on Wire (feed inside the chassis rail). Tighten the M10 bolts to the torque specified.</li> </ul>	<p>Spanner, Sockets, Drill, Torque Wrench</p>	<p>M12 = 100Nm M10 = 60Nm</p>

# FITTING INSTRUCTIONS

Toyota Prado 120/150 (Spare on door) – T7T729



## Step 4 Apply door sticker



### Instructions

Apply Towbar info label to the inside of the driver's side door Jam.

### Tools

N/A

### Torque Spec

N/A



## WARRANTY STATEMENT

The manufacturer of TAG branded products, warrants your TAG Towbar for its full product life under the following conditions:

- You can show proof of purchase.
- The towbar has been correctly installed by a suitably qualified installer.
- The towbar has not been modified or abused in any way and has only been used for the purpose intended.
- The towbar was not fitted second hand to your vehicle.

The extent of this warranty includes materials and workmanship used in the manufacture of the towbar and is to the equivalent value of current, full replacement cost.

Nothing stated or implied in this warranty limits in any way, the statutory rights that you may have.

To make a claim visit the original installer in the first instance or, if you are unable to or are not satisfied with their help, then contact us directly by email at [warranty@tagtowing.com](mailto:warranty@tagtowing.com)