

Fitting Instructions



SKU

PRODUCT

T7P711

TAG Heavy Duty Towbar to suit Mercedes-Benz Sprinter (06/2018 - on)



Scan for latest version of these instructions

SPECIFICATIONS

- Towbar Class: Heavy Duty
- Towing Capacity: 3500kg

IN THIS GUIDE

- Fitment Instructions
- Torque Settings
- Warranty Info

Towbar Fitting Instructions



Step-By-Step Instructions

Warning:

- This product is for towing purposes only and must only be loaded as shown in your vehicle Owner's Manual.
- This towbar is NOT to be drilled, cut, welded, or modified in any way.
- Check behind chassis rail and body panels before drilling to ensure no hazards are present
- All load ratings shown are under the assumption your trailer has a functional braking system installed
- When installed in positions other than the one depicted in these instructions the Tow Ball Mount may interfere or obstruct certain features of your vehicle (tailgate opening, Chassis clearance, etc.)

General:

- Before fitting this towbar read fitting instructions and check installation hardware is correct.
- Check that the towbar is suitable for the vehicle and be wary of any changes to the vehicle design that may conflict with the fitting of this towbar. (Tray, Canopy, Suspension etc.)
- After drilling, blow any filings clear, remove any swarf and treat exposed metal with a rust inhibitor.
- The high tensile fasteners supplied with this product are an integral feature to achieving the specified rating, if replacement is required ensure that fasteners of the same grade (8.8) & quality are used. Contact an authorised TAG distributor or the TAG fitment centre - (07) 3208 3022 - if further information is required.

Towbar Maintenance and Care:

It is recommended, when not in use, the Tow Ball Mount assembly and class 4 Pin and Clip is stored inside the car away from moisture to prevent standing water from forming rust. Inspect to ensure, on regular basis, fasteners are torqued to the specifications below and in good condition.

Ensure that the fitting instructions are read and understood prior to fitment

Place these instructions in the vehicle's glovebox after installation is completed

Towbar Fitting Instructions

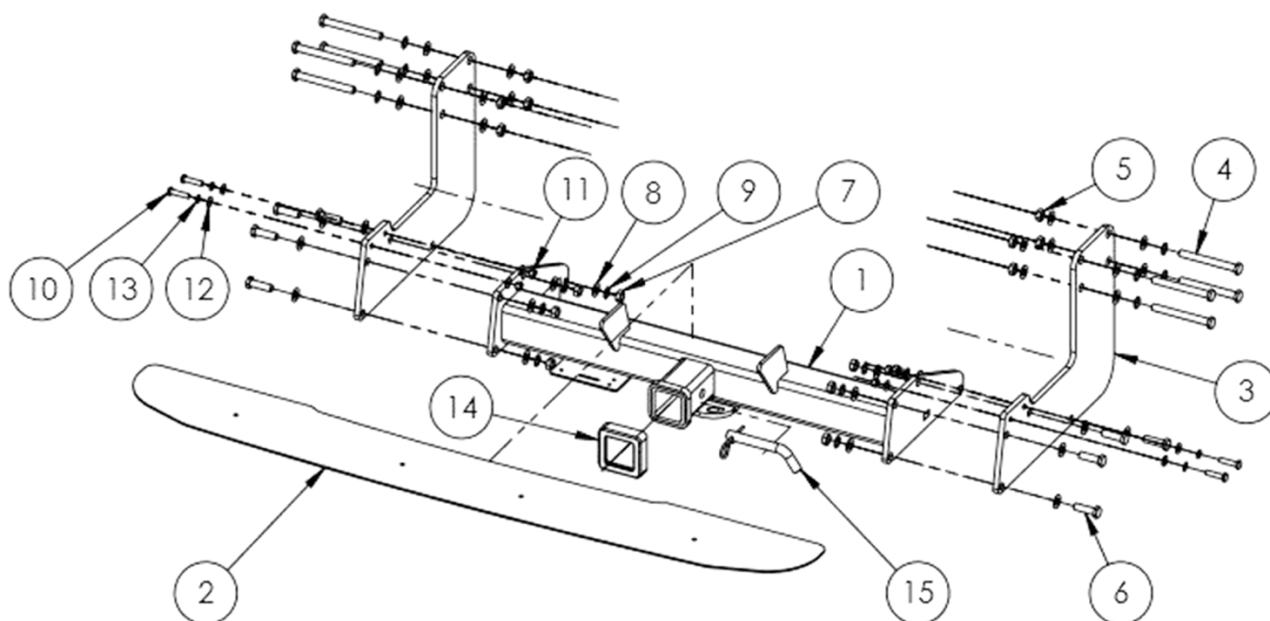

Tools Required:

Spanners/Sockets, Torque Wrench, Trim Removal Tools

| Kit Contents | | | | | |
|--------------|--------------------------|-----|----------|-----------------------|-----|
| Item No. | Description | Qty | Item No. | Description | Qty |
| 1. | Towbar Assembly T7P711 | 1 | 10. | M8x1.25x35 Bolt | 4 |
| 2. | Step Support Subassembly | 1 | 11. | M8x1.25 Nut | 4 |
| 3. | End Plate | 2 | 12. | M8 Flat Washer | 8 |
| 4. | M12x1.5x110 Bolt | 8 | 13. | M8 Shake Proof Washer | 4 |
| 5. | M12x1.5 Nut | 8 | 14. | Hitch Collar Cover | 1 |
| 6. | M12x1.25x40 Bolt | 8 | 15. | Pin & Clip | 1 |
| 7. | M12x1.25 Nut | 8 | ... | Compliance Sticker | 1 |
| 8. | M12 Flat Washer | 32 | ... | D-Shackles | 2 |
| 9. | M12 Shake Proof Washer | 16 | ... | ... | ... |

Towbar Fitting Instructions

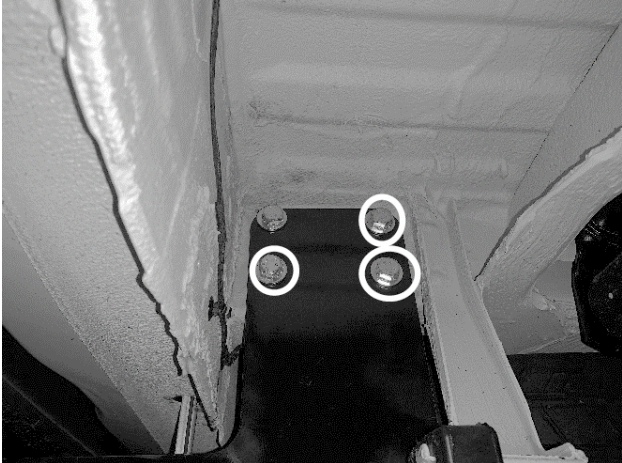

| Step 1 | Remove Factory Step Support | |
|--|--|--------------------------|
| |  | |
| Instructions | Tools | Fasteners/Torques |
| <p>Unclip 4x plastic rivets from the top of the rear step, place aside for reuse.</p> <p>Unbolt 3x bolts connecting the rear step support to the chassis on each side to remove the rear step support from the vehicle. Discard of the bolts/nuts and the step support</p> | Trim removal tools | N/A |

| Step 2 | Secure TAG Step Support | |
|---|--|--------------------------|
| |  | |
| Instructions | Tools | Fasteners/Torques |
| <p>Clip plastic rivets from step 1 through the rear step moulding into the TAG step support. This may require a bit of pressure on the moulding to align holes.</p> | Spanners/Sockets, Torque Wrench | N/A |

Towbar Fitting Instructions



| Step 3 | Attach Towbar End Plates | |
|--|--------------------------|---|
| | | |
| Instructions | Tools | Fasteners/Torques |
| <p>Loosely secure both towbar end plates to the outside of each chassis rail.</p> <p>- Using 4x M12x110 Bolt, shake proof washer and M12x1.5 Nut, and 8x Flat washer on each side.</p> <p>Tighten the bolts to hold the end plates against the chassis rails. DO NOT tighten to torque spec.</p> <p>Then use M8 hardware to fasten the step support to the towbar End Plates.</p> <p>Using 4x M12x40 Bolts, Shake Proof Washers and M12x1.25 Nuts, 8x M12 Flat Washers. Loosely secure the towbar centre section between the end plates. Ensure centre section is right side up with the chain mount bellow the hitch receiver.</p> | <p>Spanners/Sockets</p> | <p>M8 = 30Nm M10 = 60Nm M12=100Nm</p> |

| Step 4 | Apply Sticker to Door Jamb | |
|--|----------------------------|-------------------|
| | | |
| Instructions | Tools | Fasteners/Torques |
| <p>Apply Towbar info label to the inside of the driver's side door Jamb.</p> | <p>N/A</p> | <p>N/A</p> |

Towbar Fitting Instructions



Torque table for bolt tightening

| Metric GRADE 8.8 | UNC GRADE 8 |
|-------------------------|--------------------|
| M6 – 12.5 Nm | 3/8 – 50 Nm |
| M8 – 30 Nm | 1/2 – 125 Nm |
| M10 – 60 Nm | 5/8 – 245 Nm |
| M12 – 103 Nm | |
| M14 – 167 Nm | |
| M16 – 270 Nm | |

TAG Warranty Statement

SWD warrants your TAG Towbar for its full product life under the following conditions:

- You can show proof of purchase.
- The towbar has been correctly installed by a suitably qualified installer.
- The towbar has not been modified or abused in any way and has only been used for the purpose intended.
- The towbar was not fitted second hand to your vehicle.

The extent of this warranty includes materials and workmanship used in the manufacture of the towbar and is to the equivalent value of current, full replacement cost.

Nothing stated or implied in this warranty limits in any way, the statutory rights that you may have.

To make a claim visit the original installer in the first instance or, if you are unable to or are not satisfied with their help, then contact us direct by phone on 1300 669122 or visit www.swd.com.au