

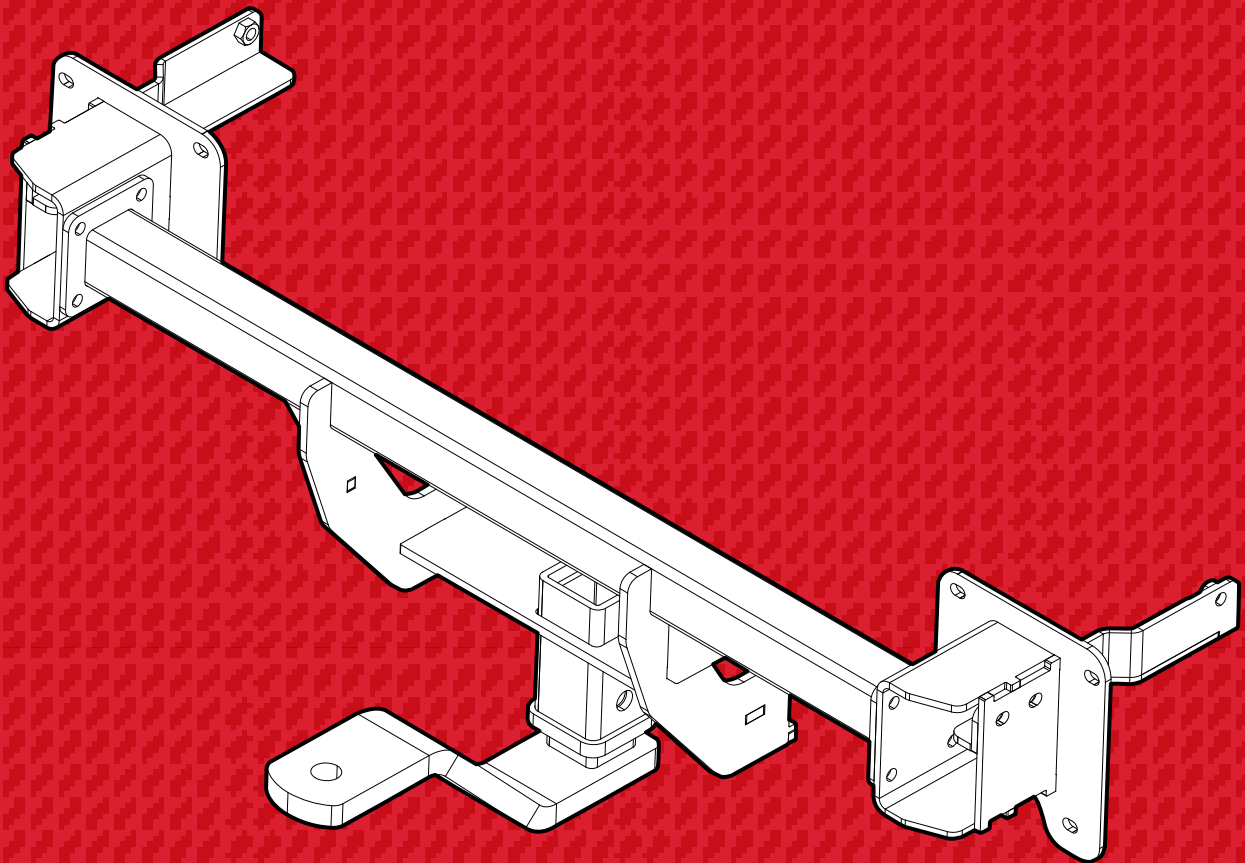

FITTING
INSTRUCTIONS

MG – MG4



PARTS LIST

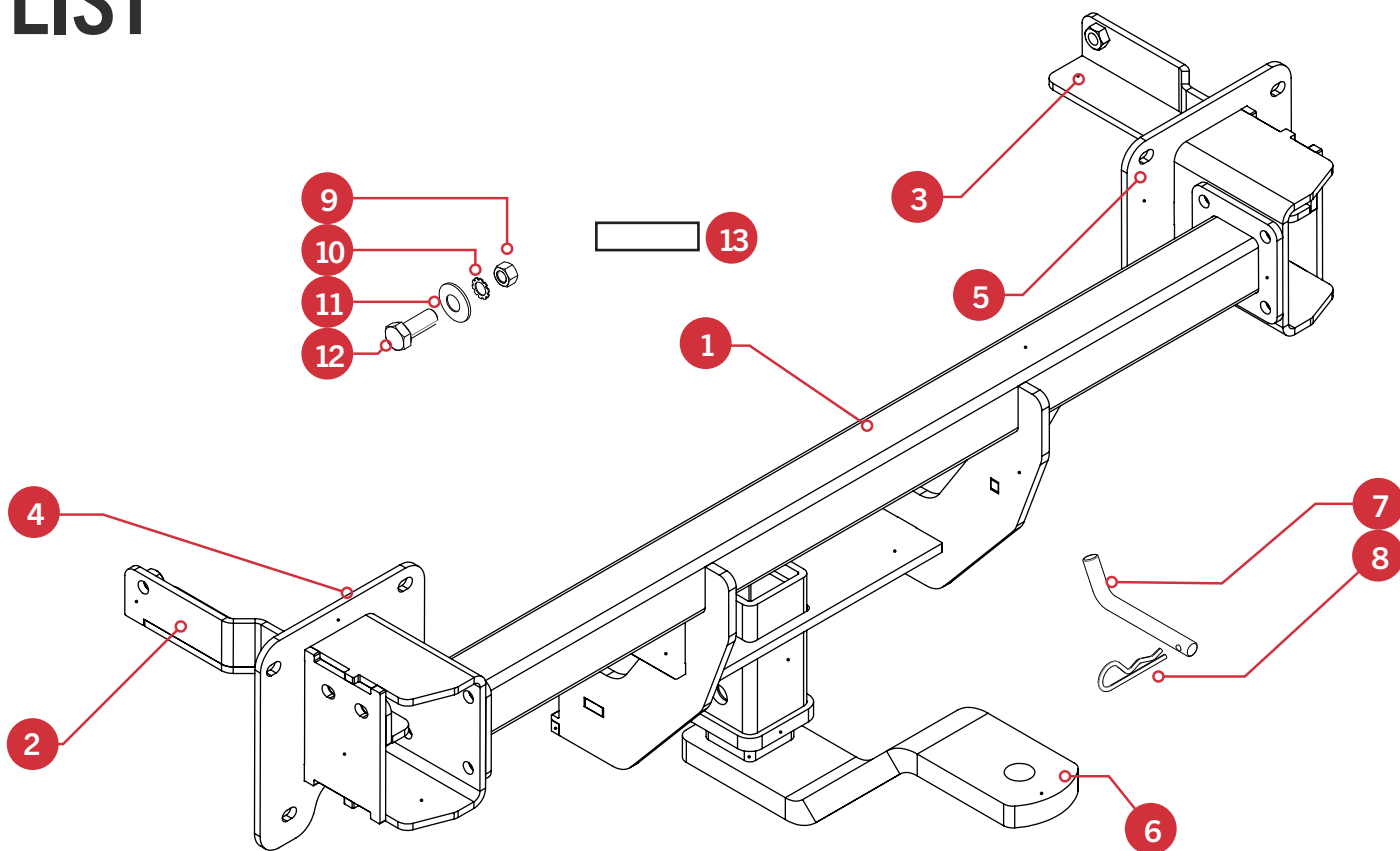

PN DESCRIPTION

1	CROSS BEAM ASSEMBLY	9	M10X35 BOLT
2	CHASSIS BRACKET LH	10	M10 FLAT WASHER
3	CHASSIS BRACKET RH	11	M10 LOCK WASHER
4	FACE PLATE BRACKET LH	12	M10 NUT
5	FACE PLATE BRACKET RH	13	LOAD RATING STICKER
6	HITCH		
7	PIN		
8	R-CLIP		



- Trim removal tool
- 5mm Allen key

- Phillips head screwdriver
- 13mm ratchet spanner

IMPORTANT INFORMATION

This product is for towing purposes only and must only be loaded as shown in your vehicle Owner's Manual.

- This towbar is NOT to be drilled, cut, welded, or modified in any way.
- Check behind chassis rail and body panels before drilling to ensure no hazards are present
- All load ratings shown are under the assumption your trailer has a functional braking system installed
- When installed in positions other than the one depicted in these instructions the Tow Ball Mount may interfere or obstruct certain features of your vehicle (tailgate opening, Chassis clearance, etc.)

GENERAL:

- Before fitting this towbar read fitting instructions and check installation hardware is correct.
- Check that the towbar is suitable for the vehicle and be wary of any changes to the vehicle design that may conflict with the fitting of this towbar. (Tray, Canopy, Suspension etc.)
- After drilling, blow any filings clear, remove any swarf and treat exposed metal with a rust inhibitor.

TOWBAR MAINTENANCE AND CARE:

- It is recommended, when not in use, the Tow Ball Mount assembly and CLASS 4 Pin and Clip is stored inside the car away from moisture to prevent standing water from forming rust.
- Inspect to ensure, on regular basis, fasteners are torqued to the specifications below and in good condition.
- Ensure that the fitting instructions are read and understood prior to fitment
- Place these instructions in the vehicle's glovebox after installation is completed

TOWBAR

STEP 01 Remove the hardware holding the tail lights in place. Carefully remove the tail lights.

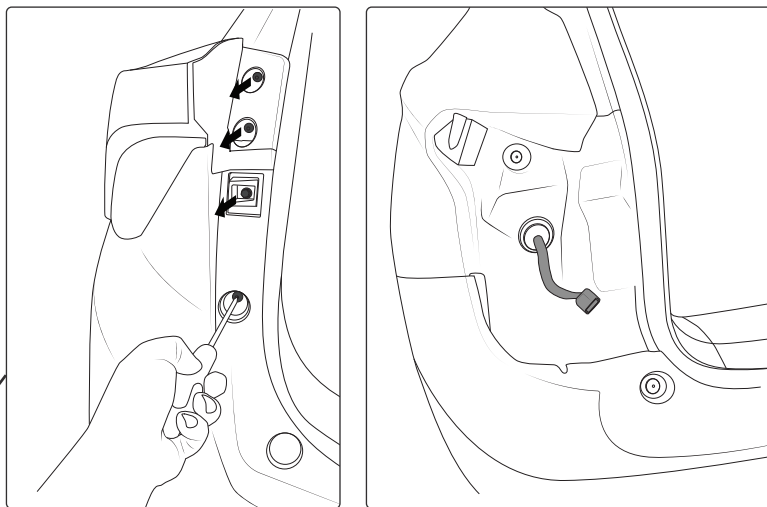

Trim tools can be used to assist.

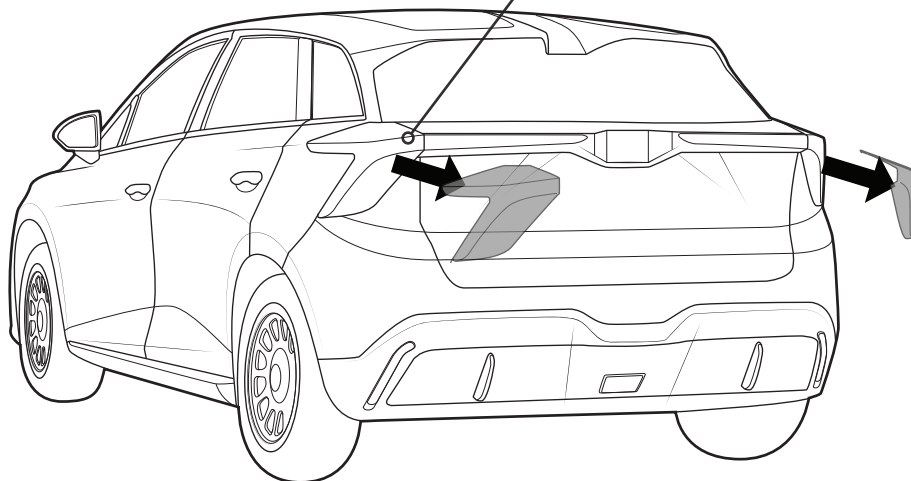

STEP 02 Using a phillips head, remove the hardware holding the bumper in place, from within the wheel well.

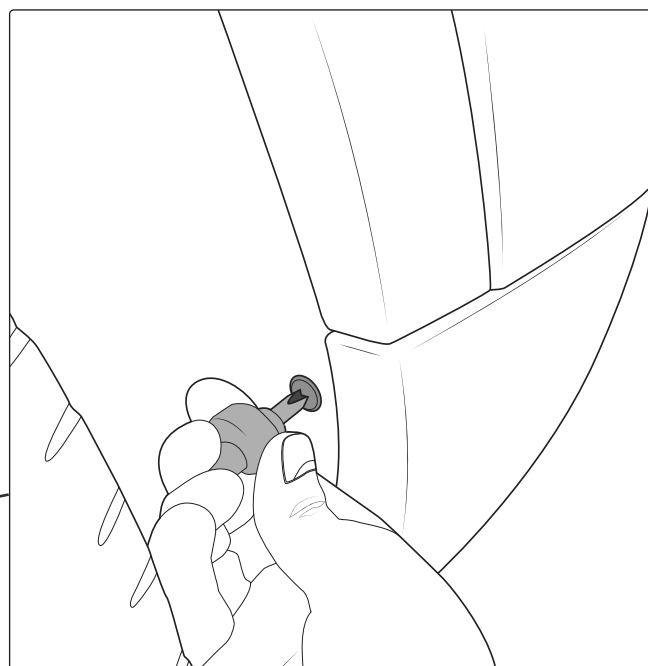
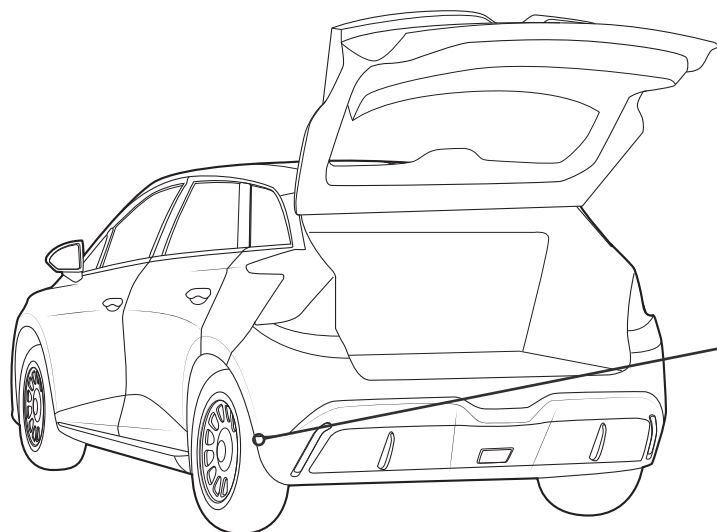

STEP 03 Using a phillips and socket wrench, remove the hardware holding the plastic panelling under the vehicle, in place.

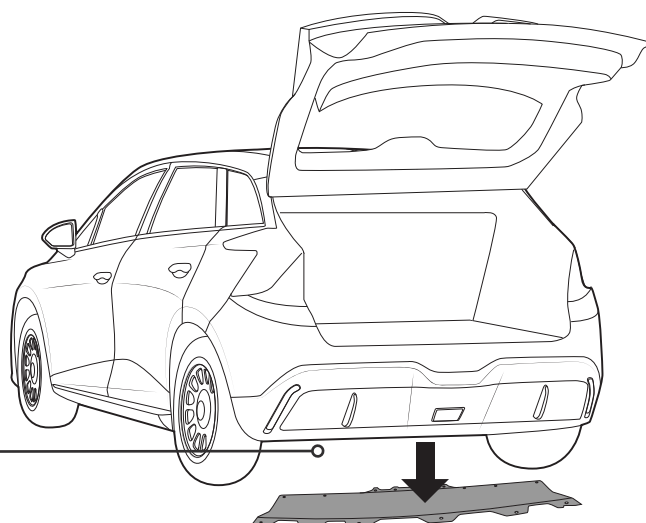
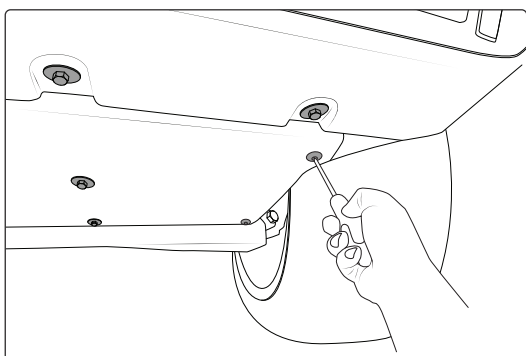

STEP 04 Carefully pull the rear bumper off and away from the vehicle. Be aware of the rear sensors attached, unclipping them as you go.

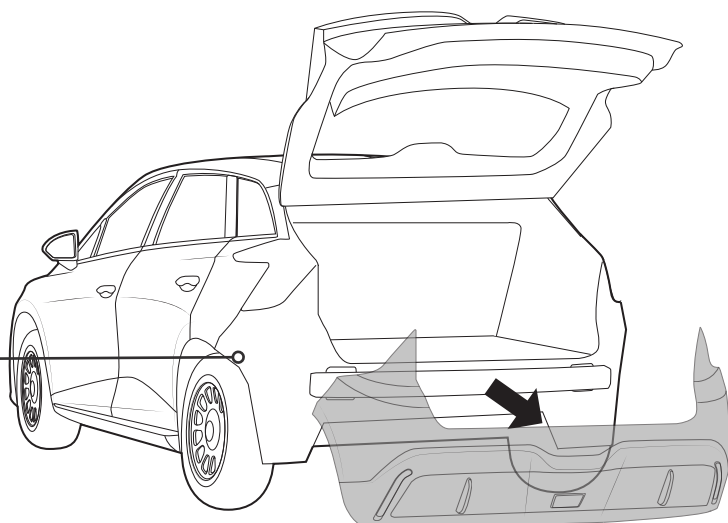
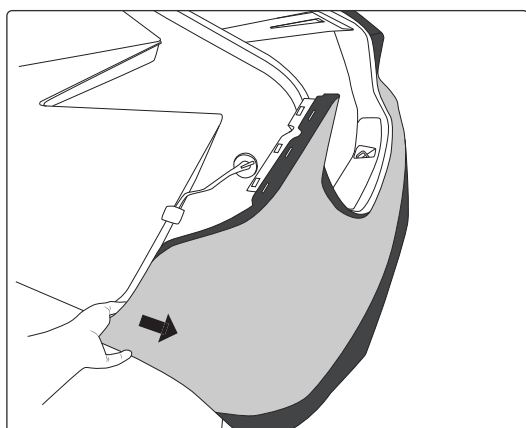

STEP 05 Remove the wiring loom from the support bar as shown. Take care to not destroy the clips holding it in place.

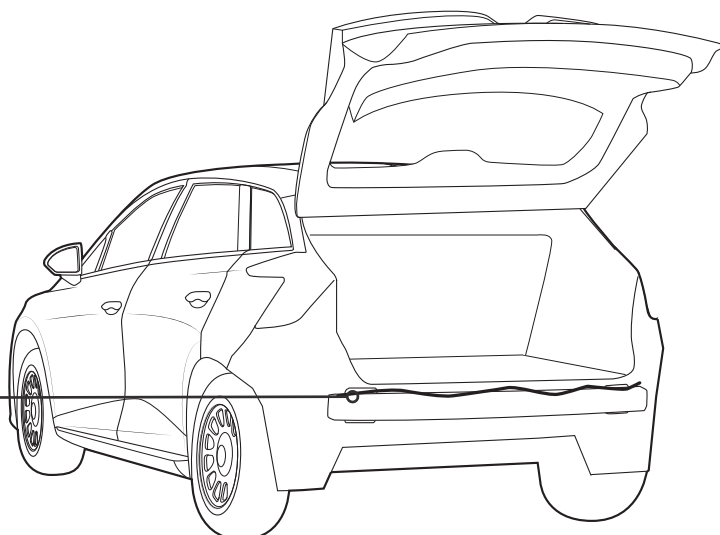
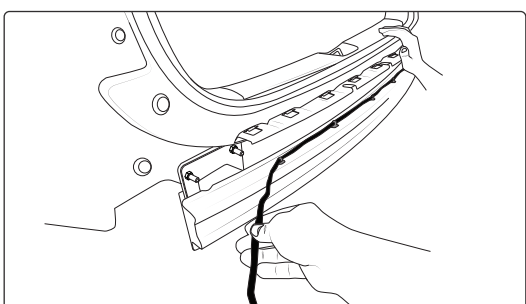

STEP 06

Remove the hardware holding the support bar in place. Take the bar off the rear of the vehicle. Be sure to keep the hardware over the stud each side. This will be used in the next step.

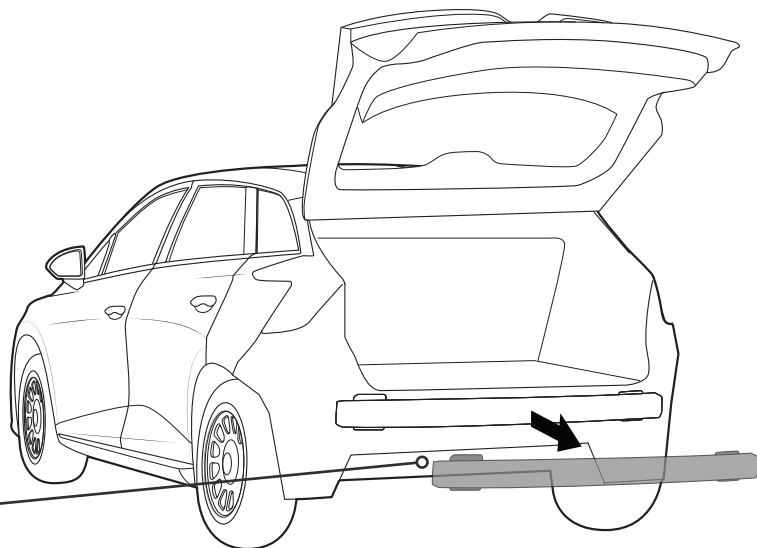
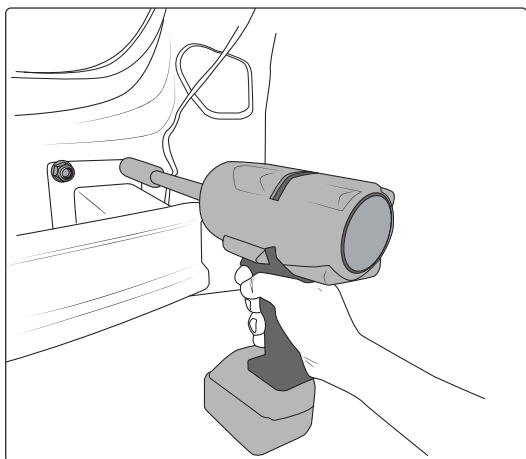

STEP 07

Place the LH and RH face plate bracket into place as shown.

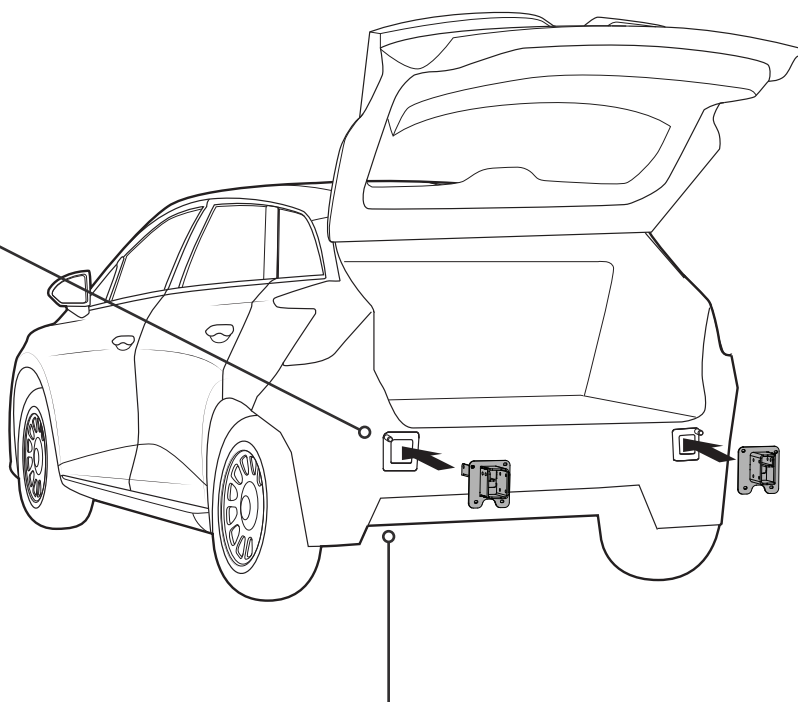
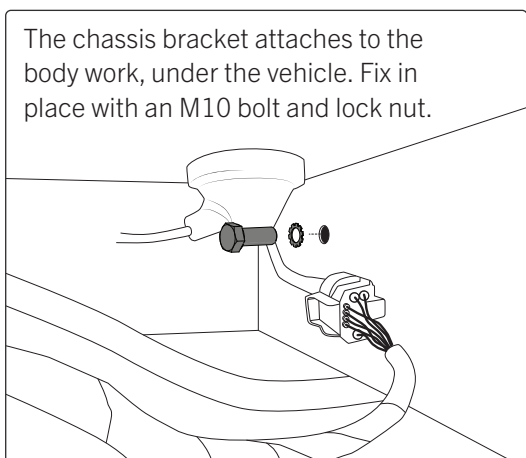
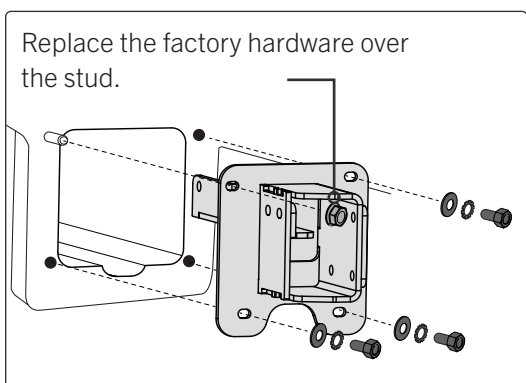

STEP 08 Remove the The plastic support brace from between the installed brackets as shown.

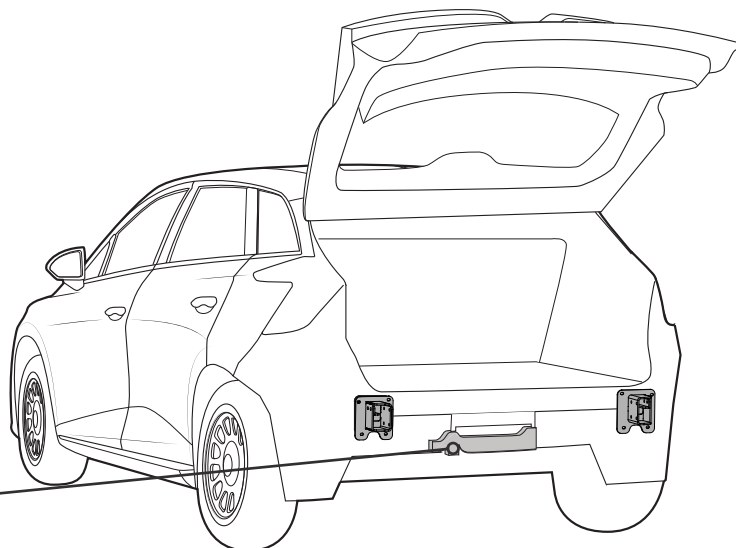
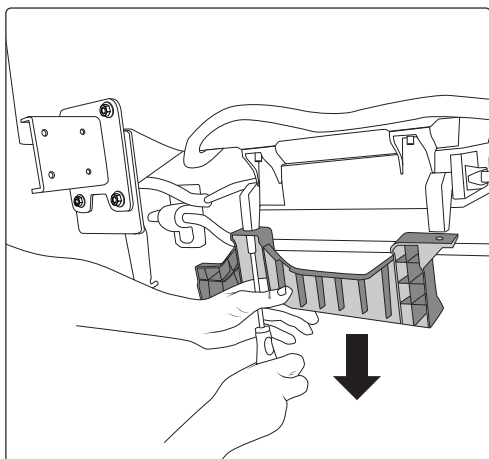

STEP 09 Lift up main cross beam and fit hex bolts with lock and flat washers, securing with nyloc nuts. All bolts are only finger tight at this stage.

Then with the assembly in place, tighten all hardware.

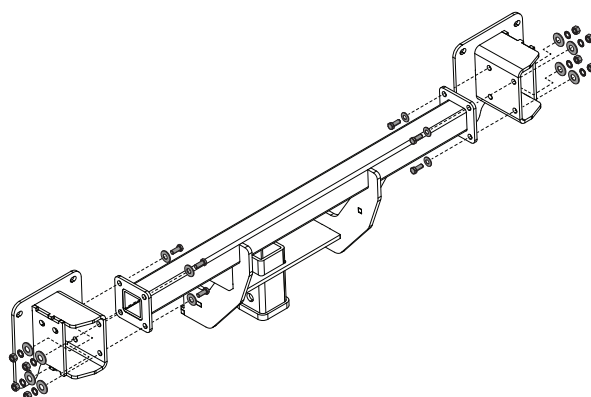

STEP 10 Place the rear bumper and plastic paneling back into position. Do not fix in place yet.

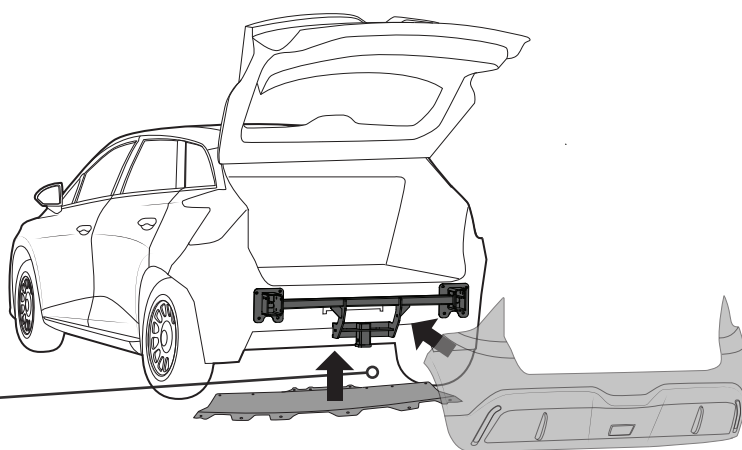
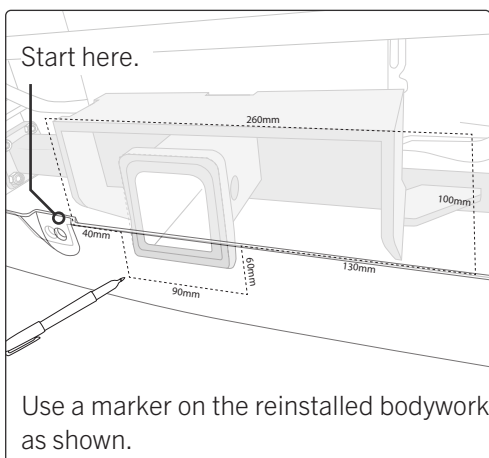

STEP
11

Remove the bodywork.

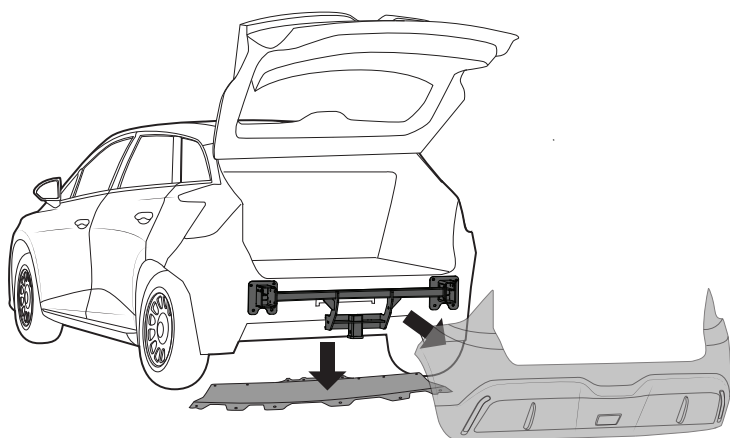

STEP
12

Use a multitool and carefully cut the bumper and plastic panelling marked in step 10.

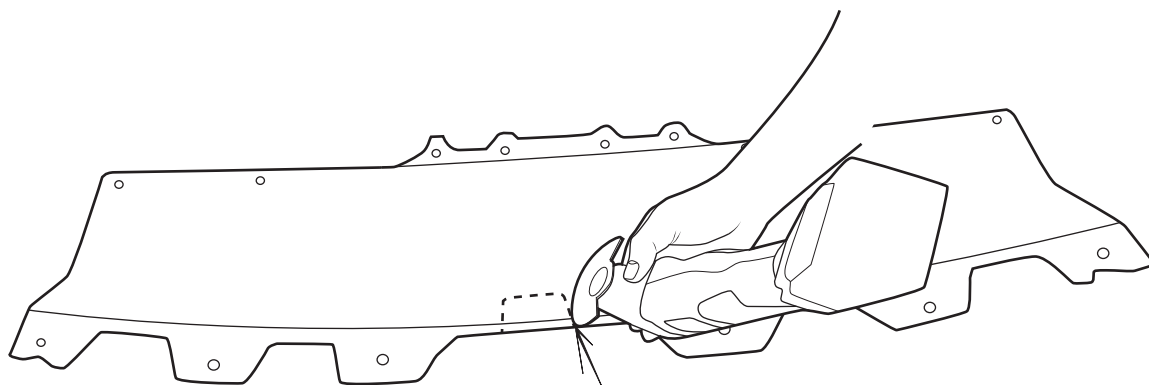

STEP
13

Refit the rear bumper and plastic panelling.

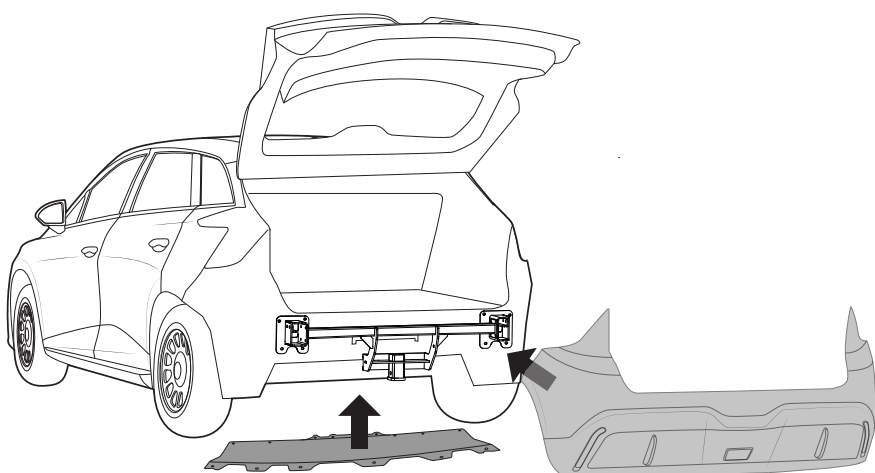

STEP 14 Trace wires from the towbar, splicing to lighting looms on the left and right of the vehicle.

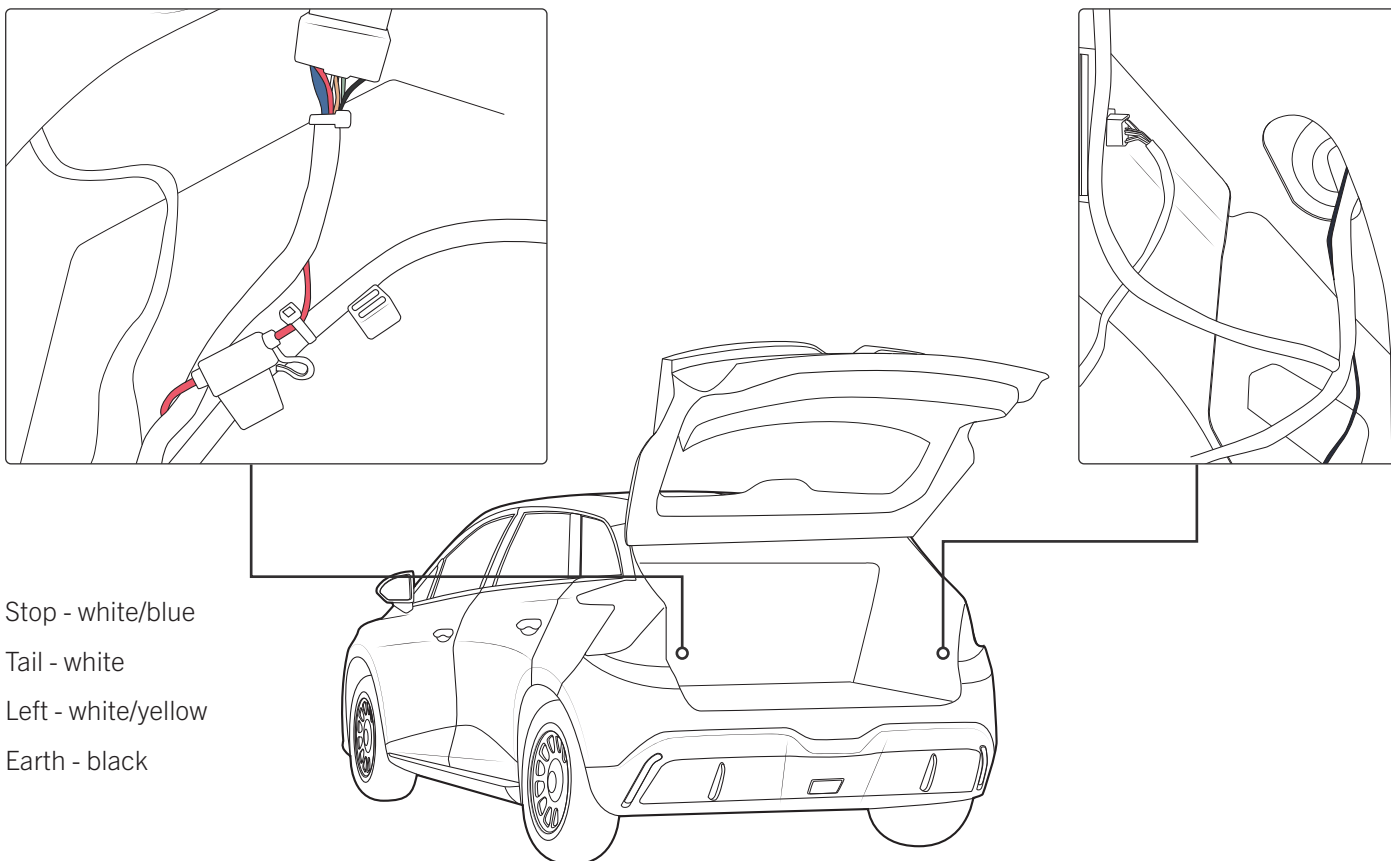

- Stop - white/blue
- Tail - white
- Left - white/yellow
- Earth - black

STEP 15 Install the 7 pin into the towbar as show.

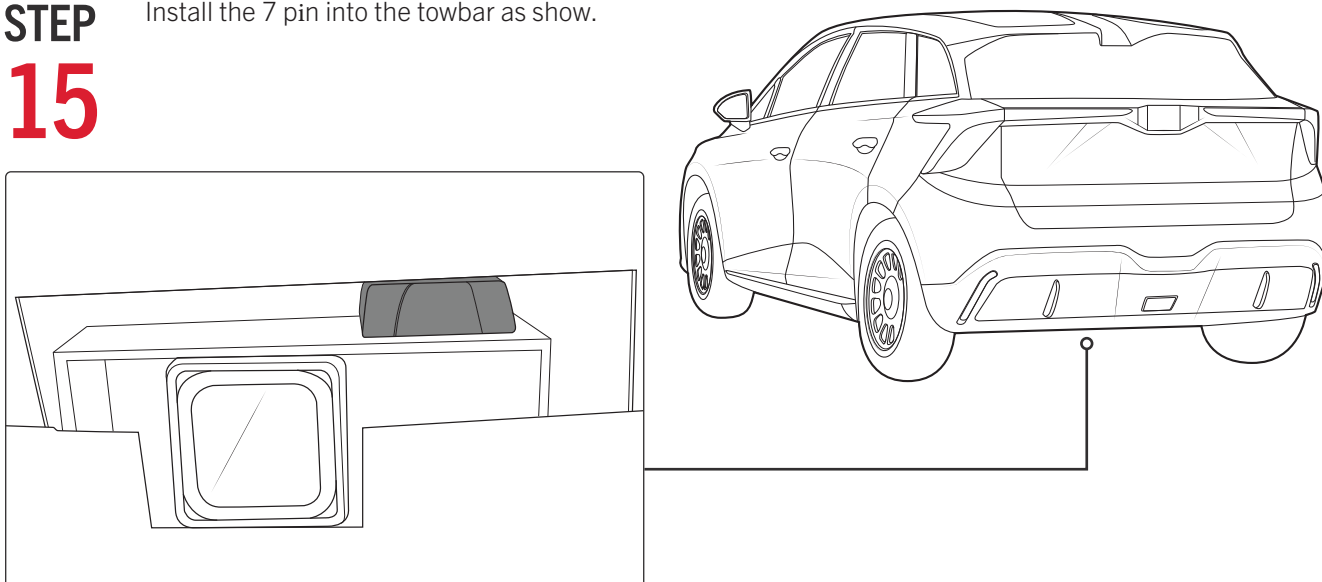

TOWBALL USAGE

STEP 01

- A)** Slide the towbar hitch into place.
 - B)** Use the pin to hold the hitch in place.
 - C)** Using an R clip, fix the pin in place.
- Fix the assembly with the anti-rattle bolt and nut.

(A)

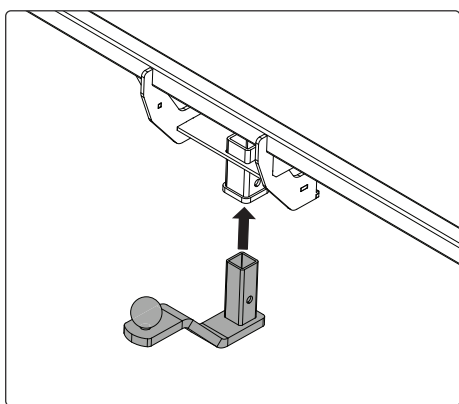

(B)

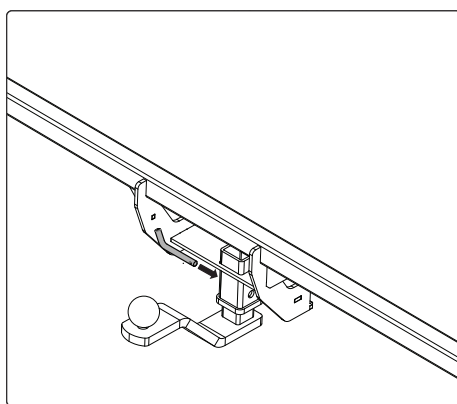

(C)

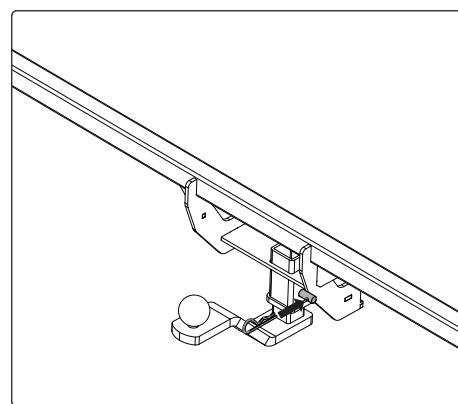

STEP 02

Install the load rating sticker

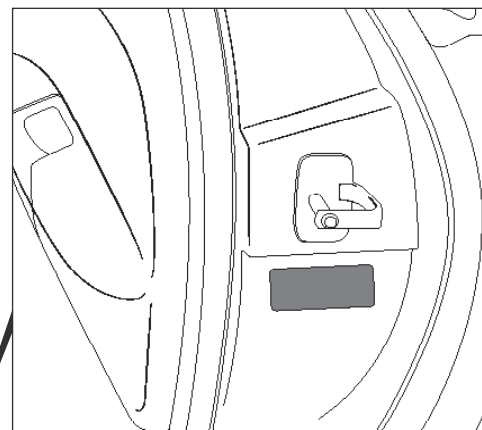
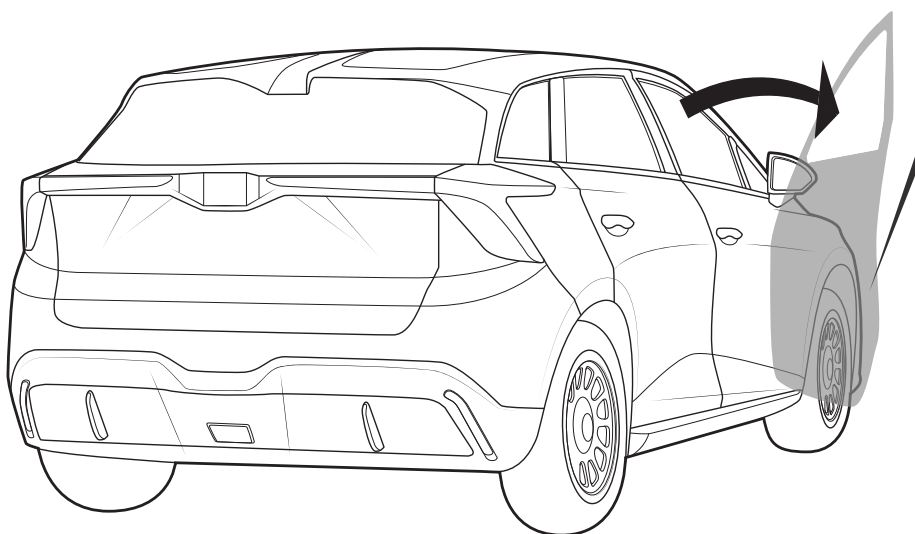



We're here to help

Want to chat? Call **1800 869 227**

evstealthsolutions.com.au



100% AUSTRALIAN
MADE AND OWNED



DRIVE AWAY
LIFETIME WARRANTY



MANUFACTURED TO
AUSTRALIAN STANDARD